



A R K T U R A

Atmosfera[®] Lotus



Adaptive Ceiling Baffles

Our Key Features

Lotus was inspired by the flower who shares the name. A bearer of enlightenment, this design can be customized to fit with your literal lighting source for a design that will stop people in their tracks. Lotus's panels are available in steel only and can be powder coated in one of our five standard colors.

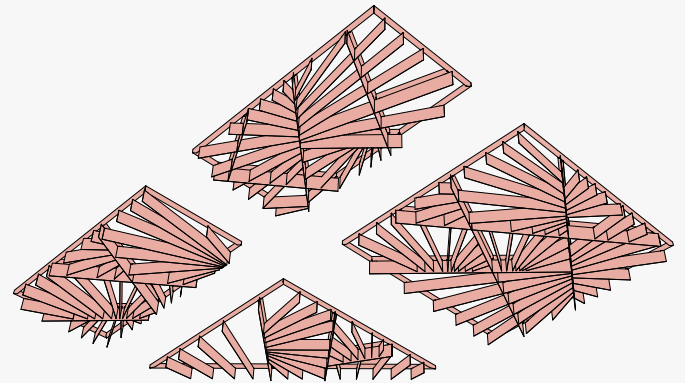

Preconfigured Solutions

Create dynamic layouts to fit any space with five predefined modules that are scripted for a seamless, voronoi spaceframe.

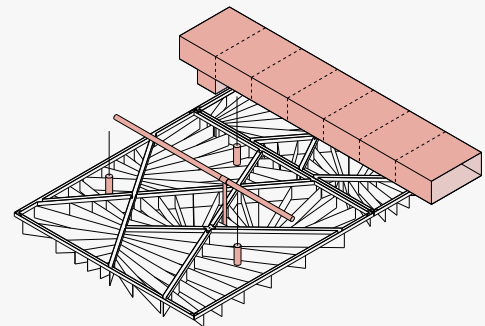

Open Plan Accessibility

Atmosfera Lotus's open design makes integrating systems above or below the modules simple and feasible. Easily removable fins and open structure makes accessing lights, HVAC, rigging points, plumbing, AV equipment, and life safety systems easy for your maintenance team.



Scan the QR or Click to Learn More about Atmosfera®

Our Key Features

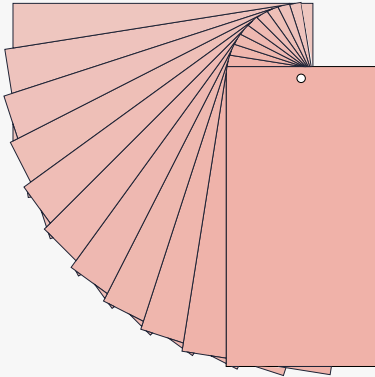

Mix and Match Colors

Atmosfera Lotus's open design makes integrating systems above or below the modules simple and feasible. Easily removable fins and open structure makes accessing lights, HVAC, rigging points, plumbing, AV equipment, and life safety systems easy for your maintenance team.

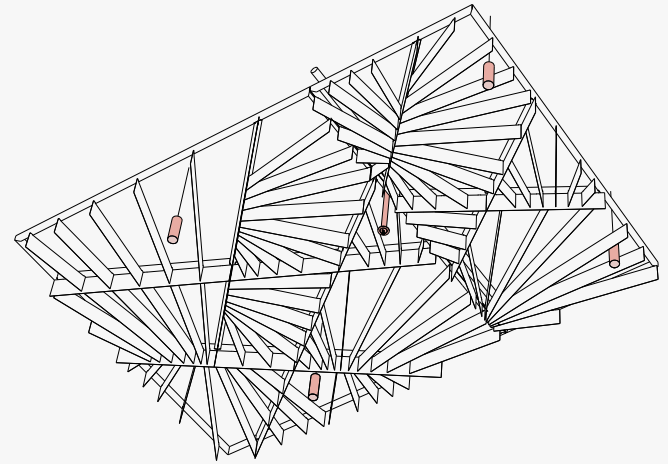

Thoughtful Integration

Lotus can accept the integration of lights and fire suppression systems in the open voids between modules.

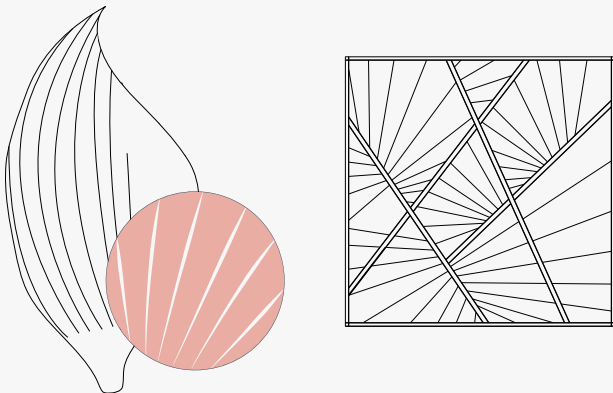

Organic, Biophilic Pattern

Create a natural, continuous, and non-repetitive feeling with Atmosfera Pulse, inspired by the mathematical, tessellated convex pattern of nature.

Inspiration



Create Impactful Ceilings Adaptable to Your Vision



Easily Integrate Lights and Other Building Systems

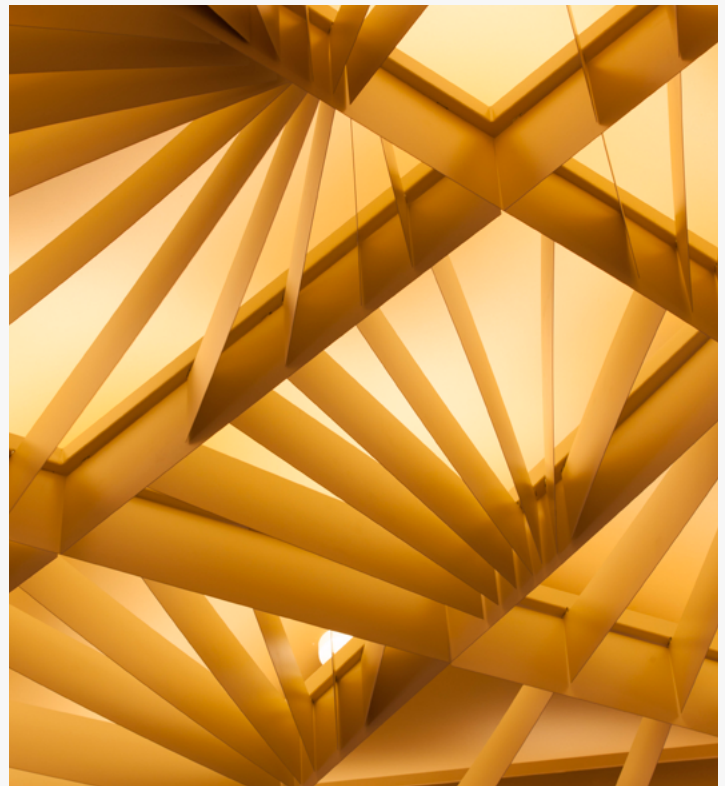

Elegant Geometric Ceiling Modules

Overview

- 1 Customization Process
- 2 Understanding the System
- 3 Available Finishes
- 4 Product Specifications

1 Customization Process

Our project management team will pre-design all of the modules to work in your space. We will coordinate around columns, lights, HVAC, building envelope, and partitions as needed.

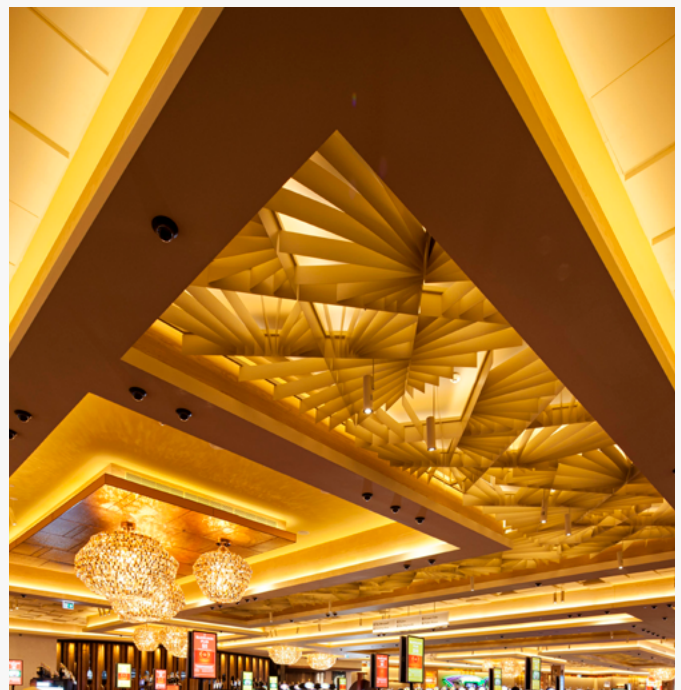
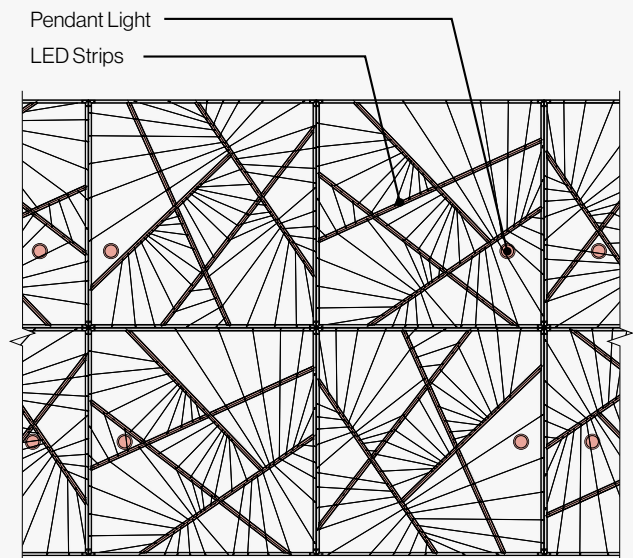
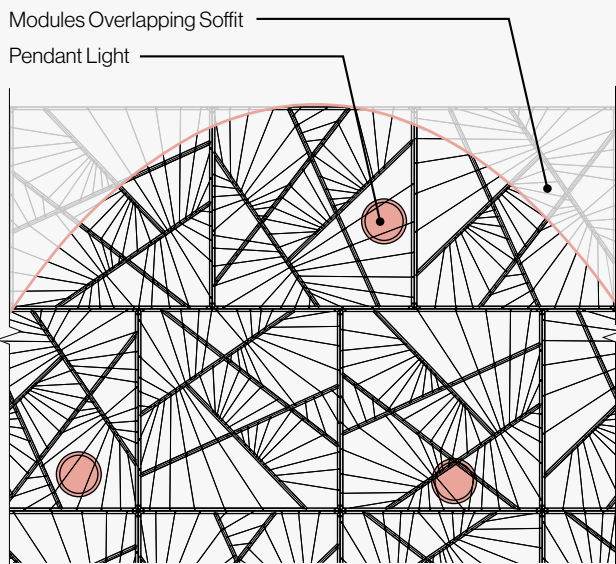

2 Understanding the System

Single Module

Atmosfera® Lotus is available in four different modules for flexibility in your design and space.

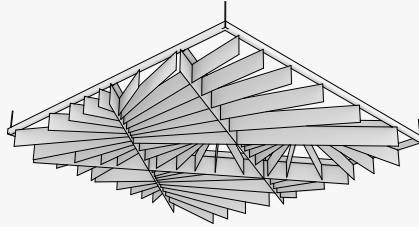

Type 1

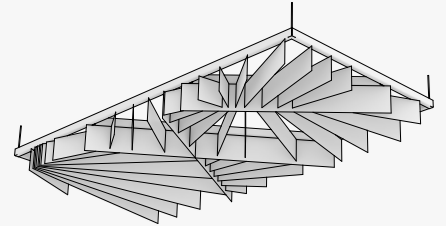

Type 2

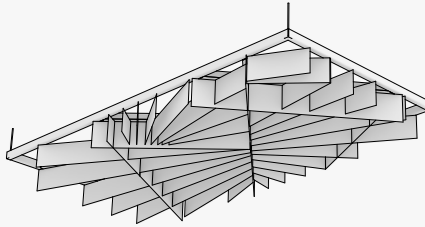

Type 3

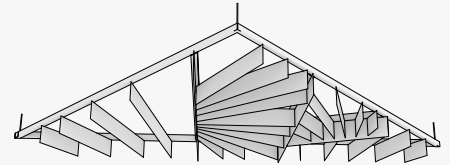

Type 4

Multiple Modules

Modules can be continuously tiled in multiple directions in plan, using the provided connecting brackets.

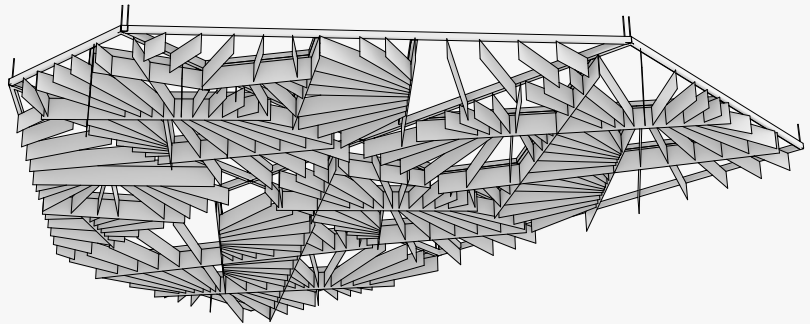

i Possible to mix and match between types.

2 Understanding the System

Understanding the Module

Plan

High openness of Lotus allows cameras, sensors, sprinklers, and lighting to be concealed between fins.

- Type 1: 87%
- Type 2: 86%
- Type 3: 82%
- Type 4: 86%

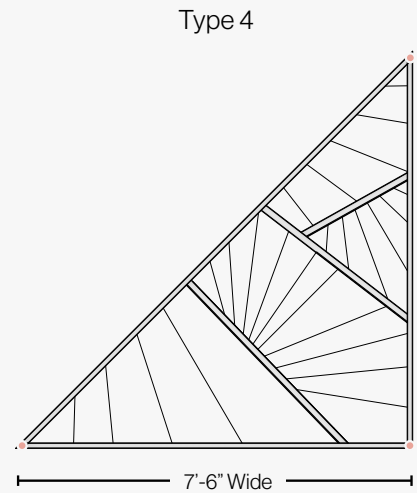
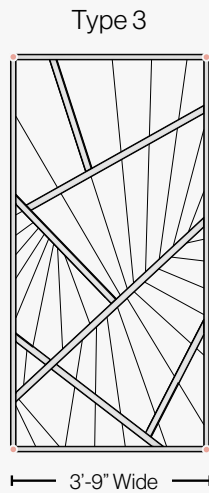
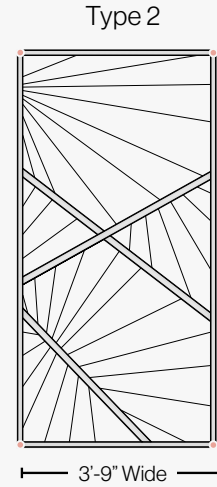
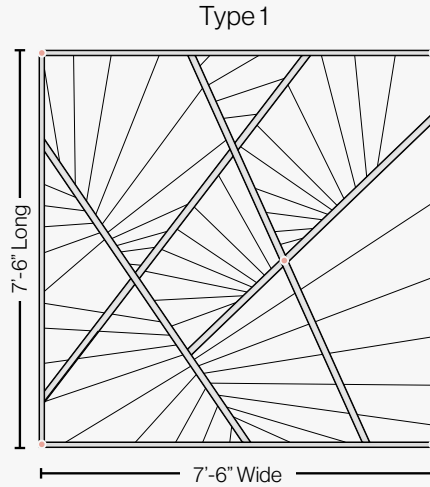

Elevation

Define the depth of fins.
Depth Range: 5" to 6"

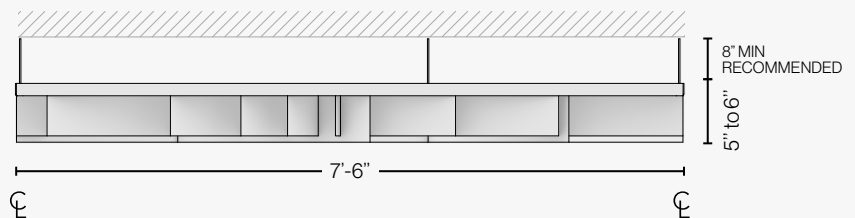

② Understanding the System

Configuration

Mix and match the different module types of Lotus for a unique effect that fits your space. Rotate modules to create more variety.

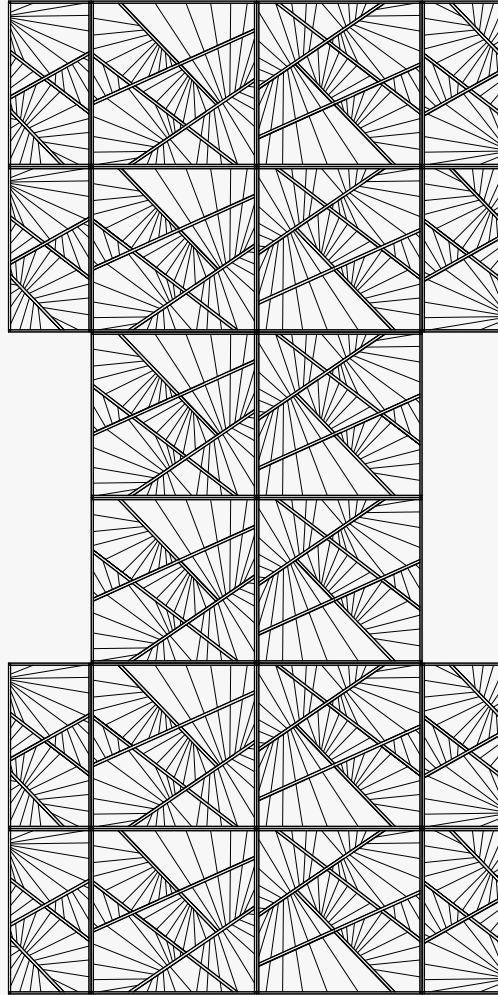

Module Rotation

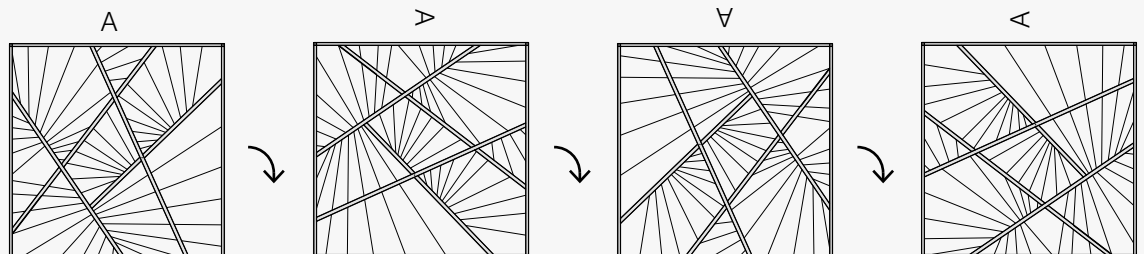

② Understanding the System

Attachment Details

Atmosfera® systems are designed for ease of install and assembly.

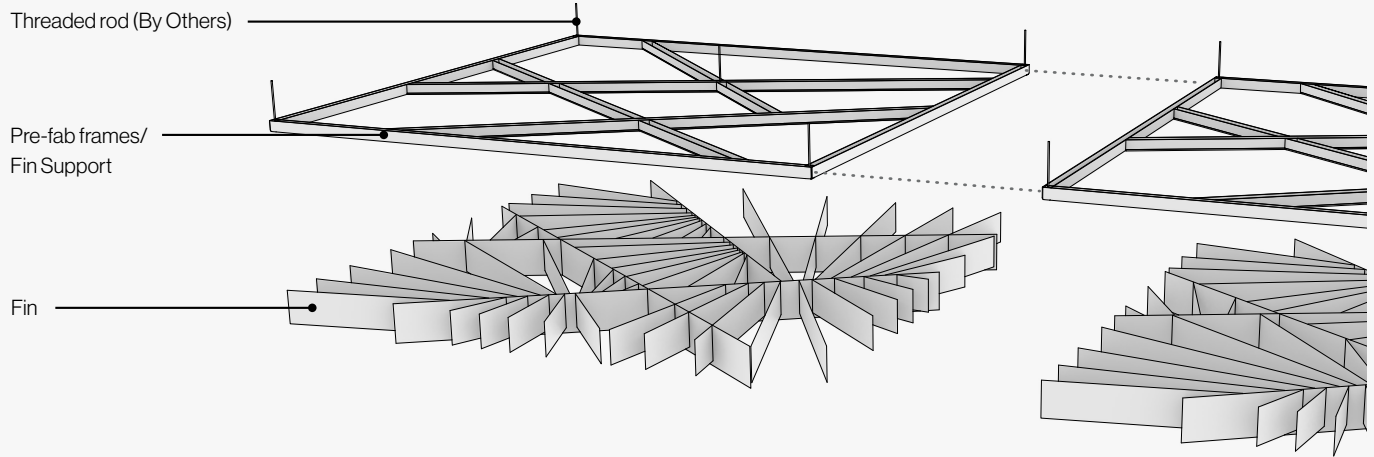

i Atmosfera® Lotus Type 1 and 2 module shown.

Rib to Fin Connection

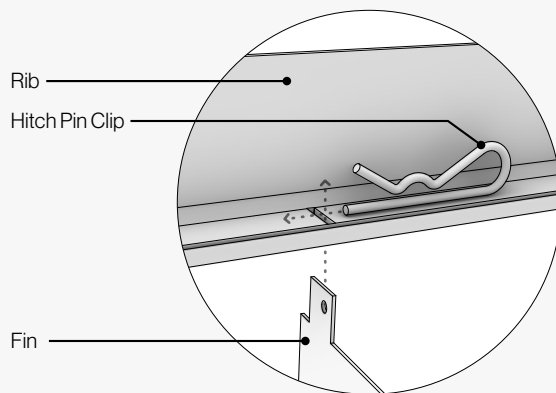

Drop Attachment

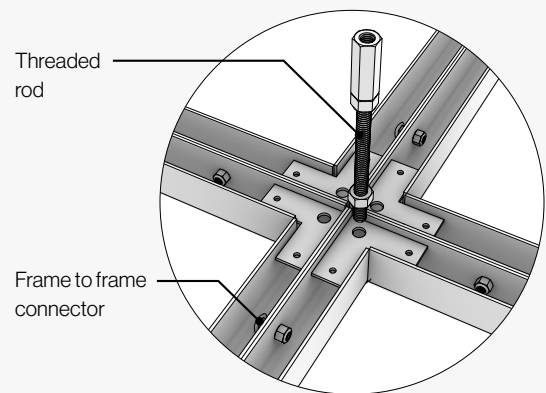

Each module combines various drop attachment types.

3 Available Finishes

Steel Fins

Powder Coat
Standard Finish
Inspired by our
Vivids Collection



Powder Coat
Standard Finish
Inspired by our
Elementals Collection

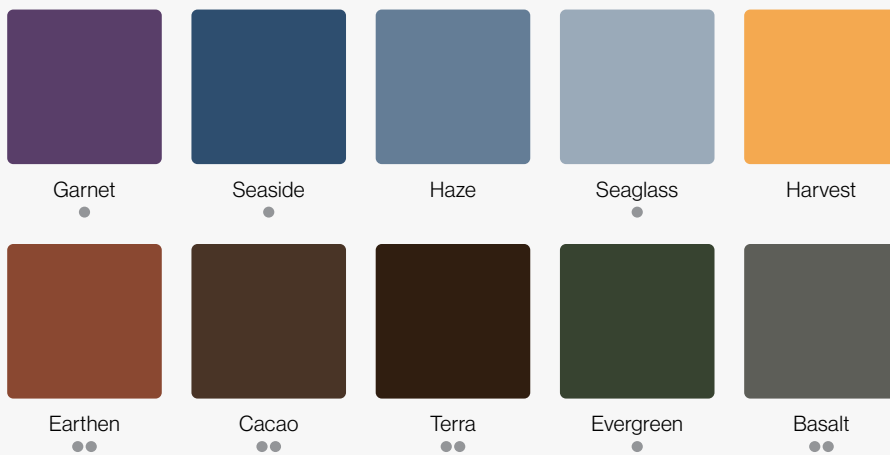

Available in:
 ● AAMA 2604 Color
 ●● AAMA 2604 or 2605 Color
 *Non stock, fee **upcharge**



3 Available Finishes

Module Color

Powder Coat
Standard Finish
Inspired by our
Essentials Collection



					
T-Grid White* (Matte) ••	Arktura White (Matte) ••	Brilliant White* (Gloss) •	Silver Metallic (Semi Gloss) ••	Jet Black (Matte) ••	
					
Aviator Gray (Gloss) ••	Aviator Gray (Matte) ••	Steel Gray ••	Shadow ••	Midnight ••	Coffee •
					
Raw Umber •	Caramel ••	Sandstone ••	Oat ••	Sunflower* •	Torch •
					
Spirit Red (Matte) •	Redwood •	Boysenberry •	Azure* •	Blue Steel* •	Harbor Blue •
					
Forest Green ••	Hartford Green •				

Powder Coat
Premium Metallic
Finish

		
Chilled Champagne (Semi Gloss) ••	Sun Kissed Bronze •	Burnished Bronze (Semi Gloss) ••

Custom Powder Colors

We offer premium non-stock RAL and custom color match options as well. Contact your sales rep for more information.

	
Non-stock Metallic	Non-stock RAL

Available in:

- AAMA 2604 Color
- AAMA 2604 or 2605 Color

* Non stock, fee **upcharge**

* This color was designed to pair with Armstrong color "WH" grid and trim.

4 Product Specifications

System Specs

Fin Material	20GA Steel (Full Module)	20GA Steel (Half Module)
Module Dimension	7'-6" x 7'-6"	7'-6" x 3'-9"
Fin Depth	7 5/8"	7 5/8"
Openness in Plan	87%	82% & 86%
Frame Material	Steel	
Fire Rating	ASTME84 - Class A	
Acoustics	True NRC®: Results Vary	
Attachment Method	3/8" Threaded Rod	

This product may be the subject of one or more patents or pending patent applications. See www.arktura.com/intellectual-property for related patent information.