



A R K T U R A

# SoftGrid<sup>®</sup> Flux



Ceiling **Baffles + Light**

*Fueling Possibilities<sup>®</sup>*

# Our Key Features

Flux's acoustic ceiling modules create a geometric abstract shape, thanks to its interweaving network of panels made of Soft Sound® material that provides acoustic support where you need it. These intricate modules can connect together to provide acoustic comfort to an entire room or be used separately for a more focused design.



## Reduce Noise & Enhance Acoustics

SoftGrid®'s Soft Sound® material reduces the impact of noise from everyday annoyances like ringing, typing, and chatter resulting in a more pleasant and productive environment. SoftGrid®'s material works in concert with the design to help reduce and control reverberations leaving a lasting impression at scales ranging from assembly halls to conference rooms.

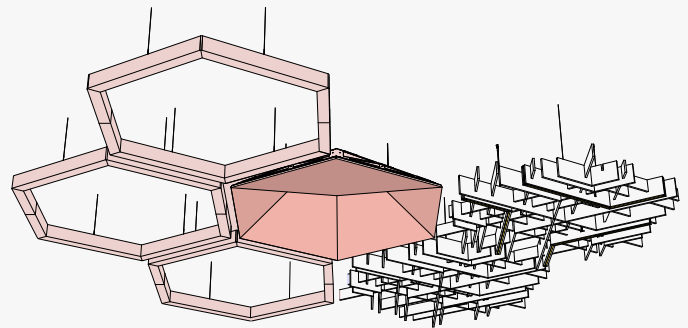

## Compatible with Hexagonal Systems

SoftGrid®'s geometric modules are compatible with other hexagonal systems from Arktura, including SoftGrid® Hex, SoftShapes™ Hex, and SoundStar® to fully immerse any space in acoustic attenuation.



Scan the QR or Click to  
Learn More about SoftGrid®

## Our Key Features

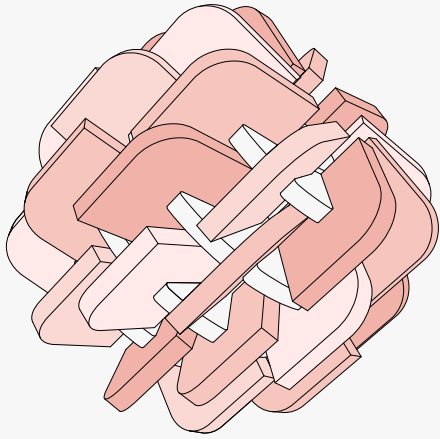

### Expansive Soft Sound® Library

Choose from a large library of Soft Sound® colors and wood textures. Mix and match colors to accent fins and complement the color scheme of your space.

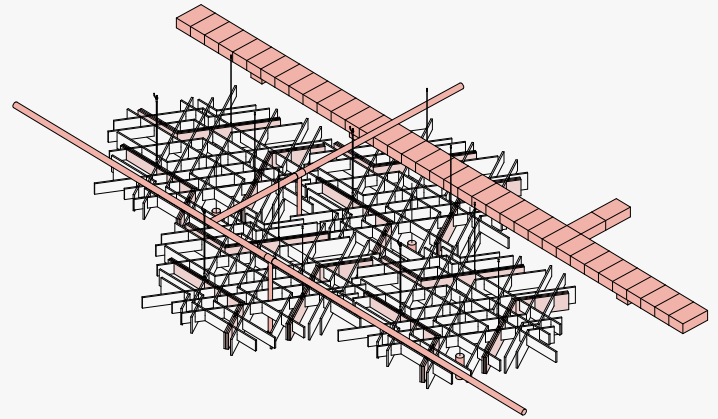

### Open Plan Accessibility

SoftGrid®'s open grid design makes integrating systems above or below the modules simple and feasible. Easily removable fins and open structure makes accessing lights, HVAC, rigging points, plumbing, AV equipment, and life safety systems easy for your maintenance team.

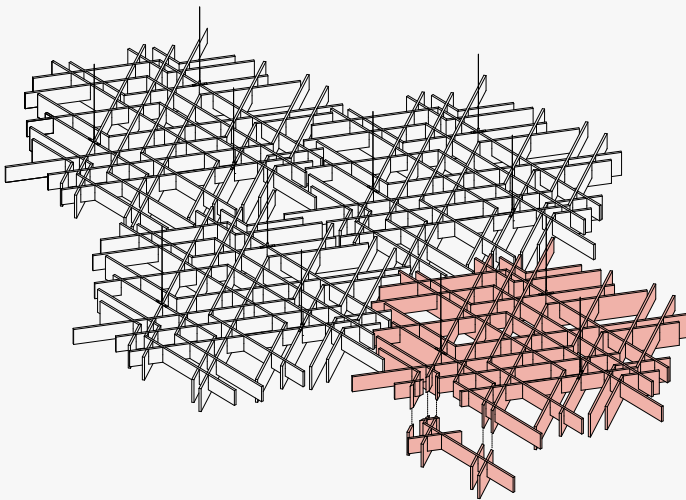

### Field Modifiable

SoftGrid® modules can be trimmed down to a minimum of four fin intersections. By rearranging our adjustable hangers, we make it easy for you to specify standard modules that can be easily field-modified around anticipated or unforeseen site conditions during install.

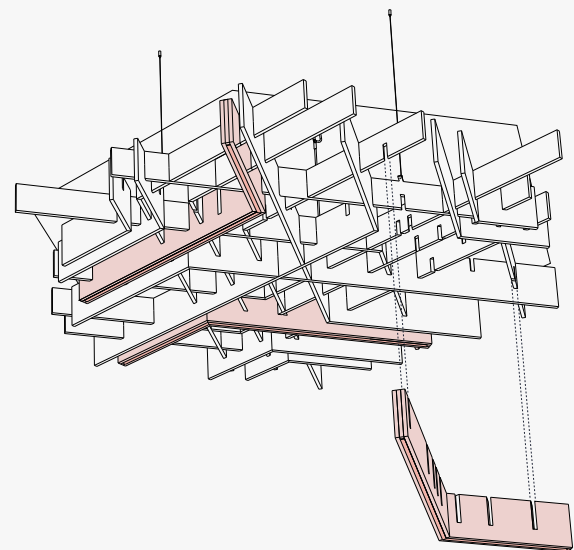

### Integrated Lighting

Form meets function as this acoustic module now supports integrated lighting. Bring illumination to your next project with powerful LED lighting built directly into these fins.



# Inspiration



**Stagger Modules and Mix Finishes to Create Unique 3-Dimensional Duo Tone Effects**



**Create Unique Configurations in Natural Wood Tones**



**Improve Acoustic Wellness in Collaborative Settings**



# Overview

- 1 Understanding the System
- 3 Available Finishes
- 2 Optional Lighting
- 4 Product Specifications

## 1 Understanding the System

### Standard Module

Modules are made from Arktura's lightweight & durable Soft Sound® acoustical material with stainless steel brackets.

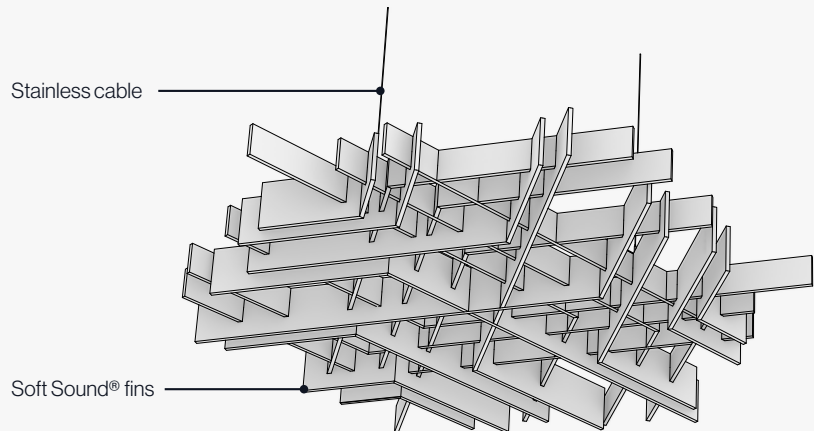

### Designing with Modules

Modules can be tiled in multiple directions in plan utilizing their hexagonal geometry. Modules may all be stepped in section or placed in a continuous plane.

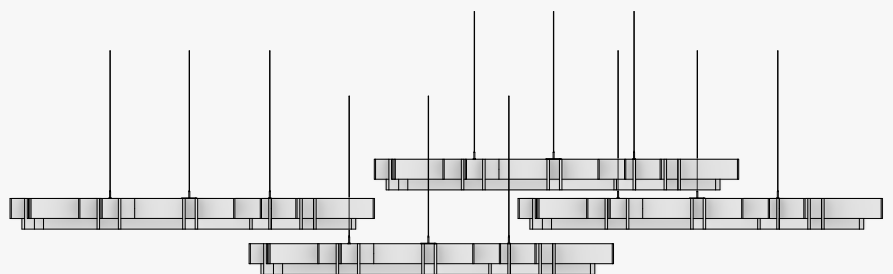
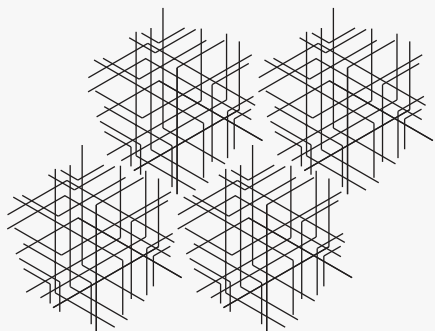
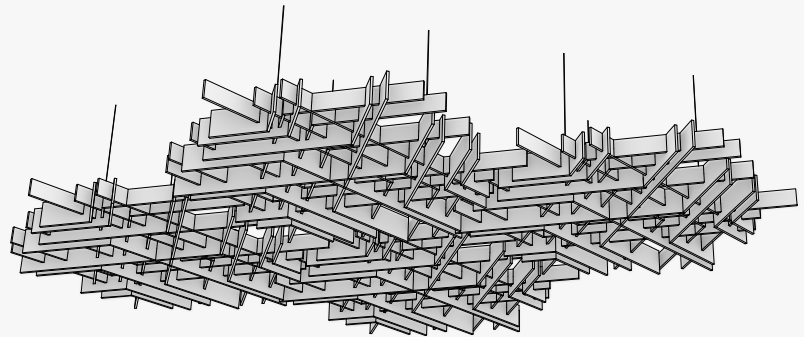

 An install template is sold as a guide to the drop points for each module.

# 1 Understanding the System

## Understanding the Module

### Plan

87% open in plan.

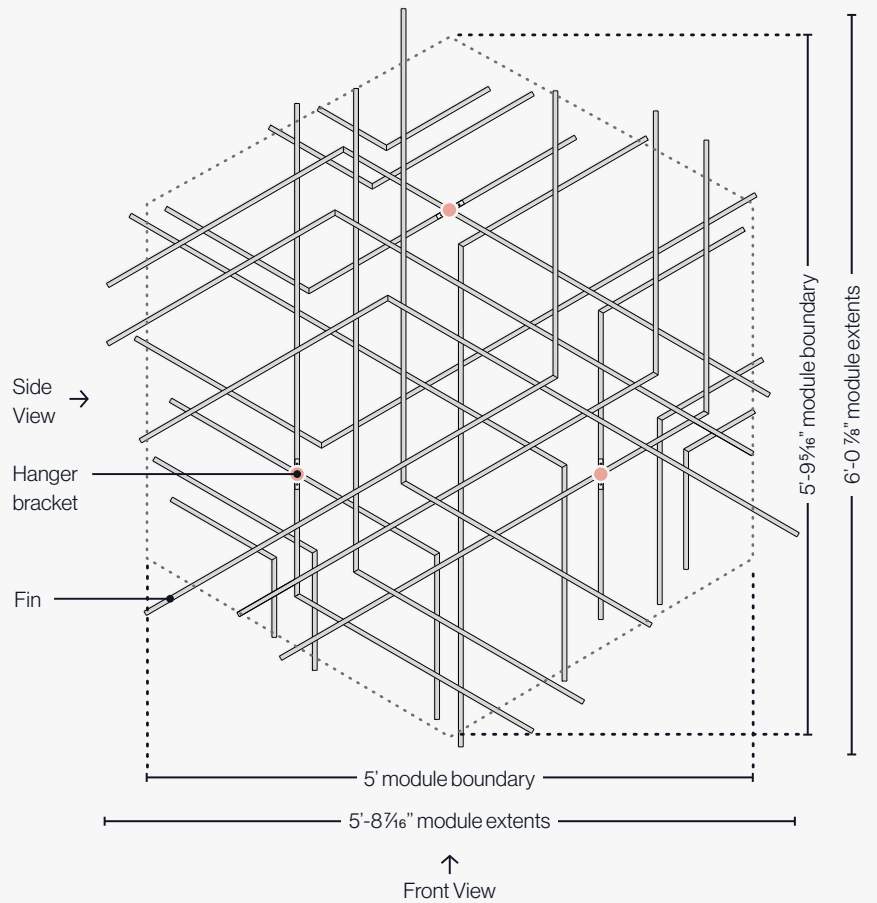

### Elevations

Fin depth varies from 4" to 5 <sup>5</sup>/<sub>16</sub>" deep.

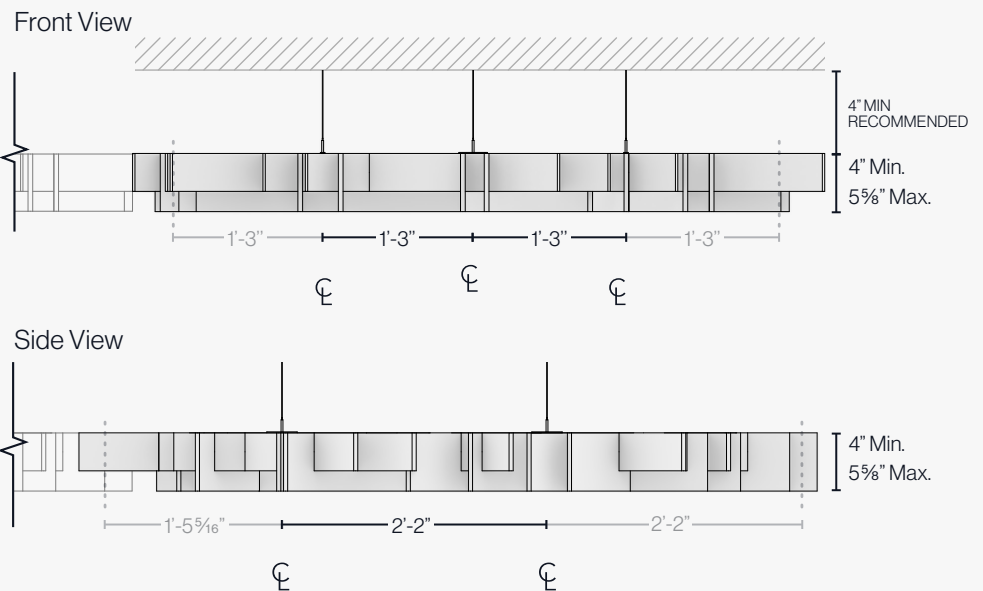

# 1 Understanding the System

## Attachment Details

To minimize the visual impact of our hanging system, we provide 1/32" stainless cables and a micro quick-release wire clamp with hanging brackets at 3 locations.

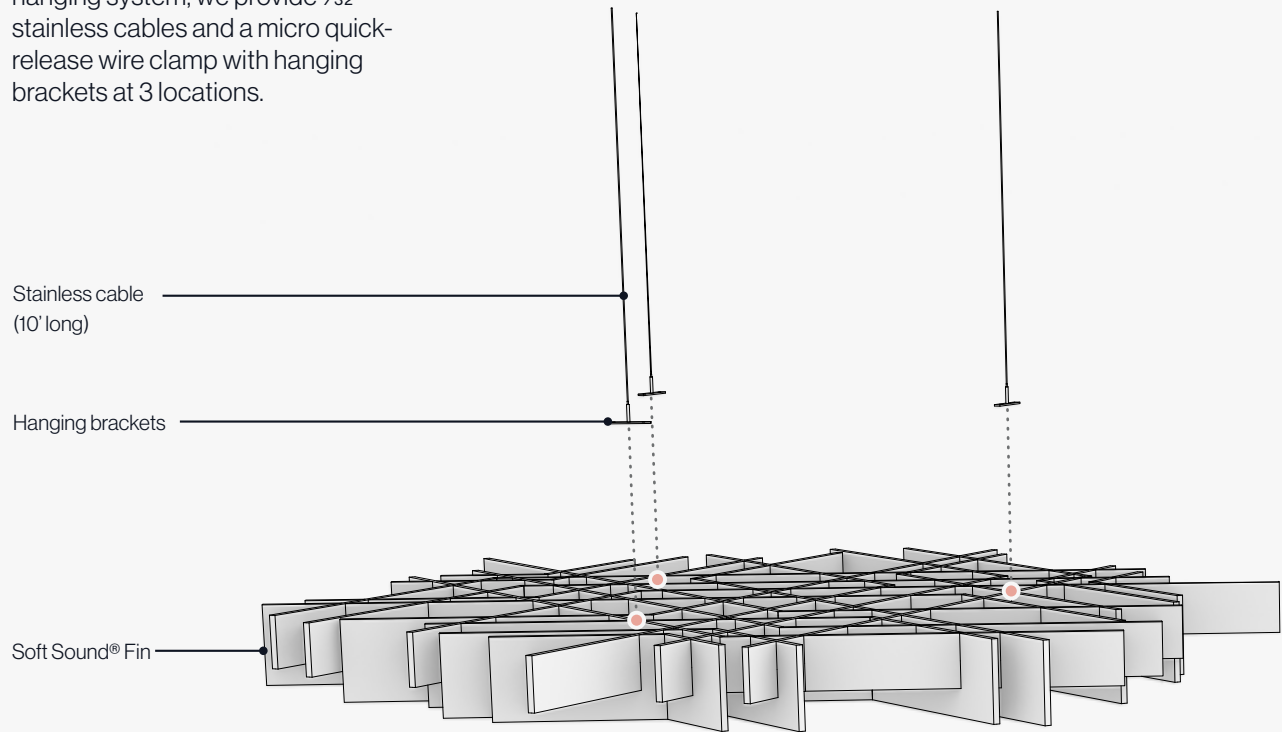

**Hanging Bracket Attachment**

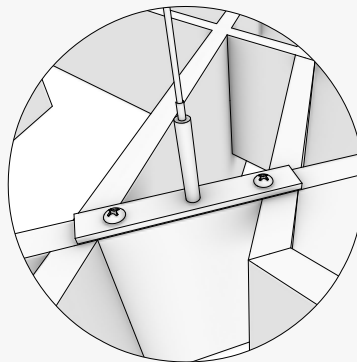

**Module Joining Bracket**

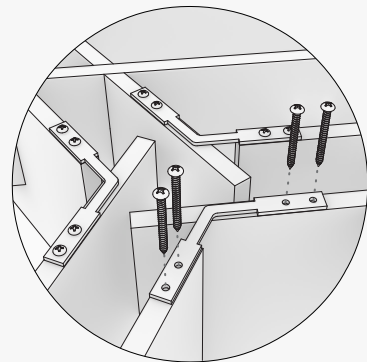



# 1 Understanding the System

## Combining With Other Products

### Perspective

Create drama in your design by mixing other hexagonal SoftGrid®, SoundStar® and SoftShapes™ modules together.

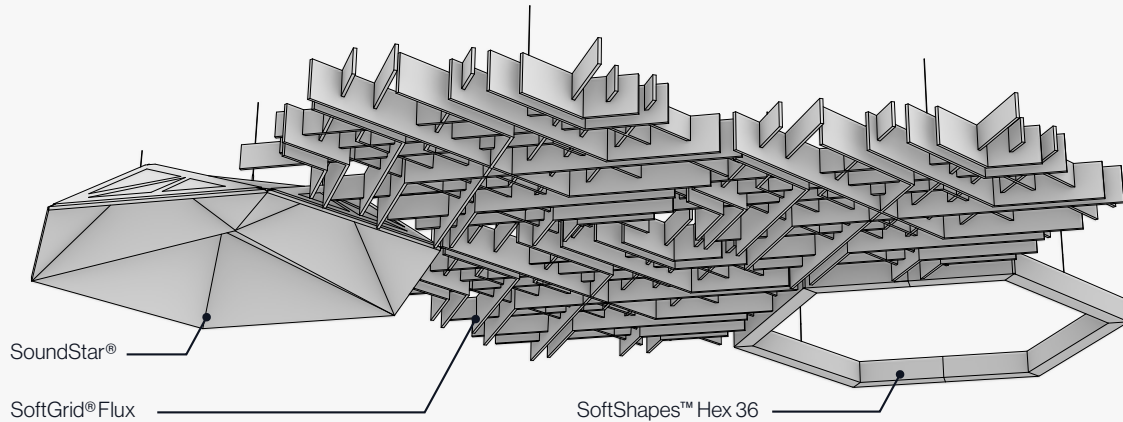

### Plan

SoftGrid® Flux (A)  
SoundStar® (B)  
SoftShapes™ Hex (C)

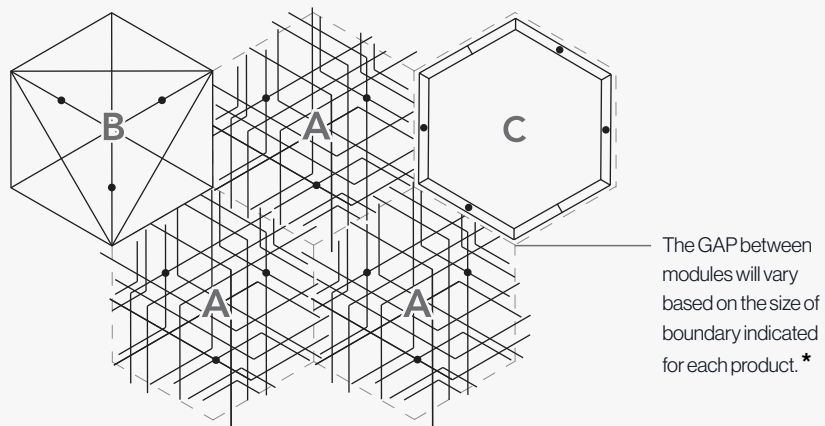

\* To combine SoftGrid® Flux with other products please contact your Arktura Rep. to request Product Installation Manuals

### Trimming

When combining SoundStar® and SoftShapes™ Hex, some Soft Sound® fins must be trimmed.

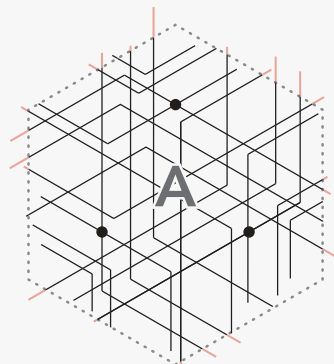

 Trim instructions in the installation manual.

## 2 Optional Lighting

### SoftGrid® Light

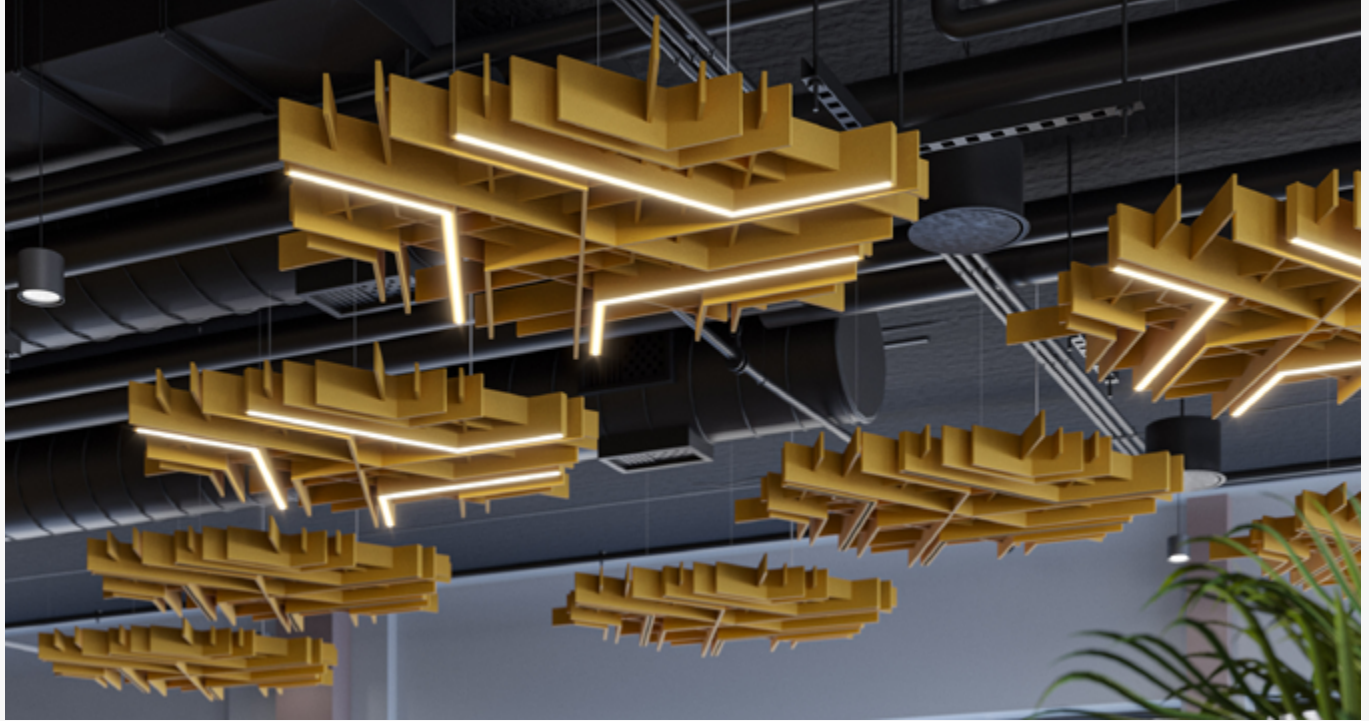

Mix and match traditional modules with SoftGrid® Light



SoftGrid® Light can be used as your main source of light

## ② Optional Lighting

### SoftGrid® Light

#### Perspective View

Modules are made from Arktura's lightweight & durable Soft Sound® acoustical material with stainless steel brackets and now feature an integrated light system.

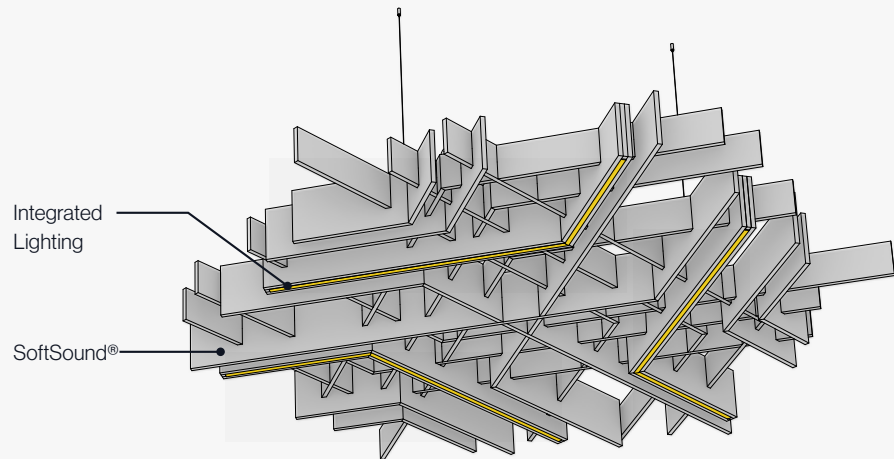

#### Plan View

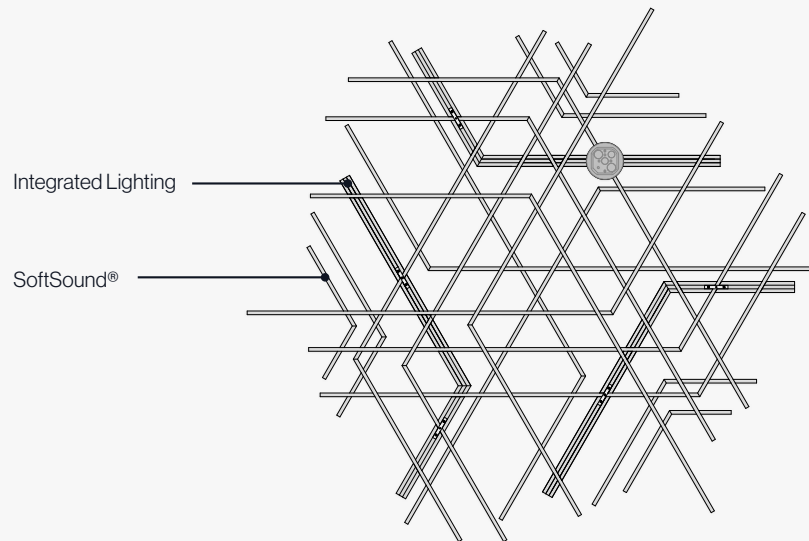

### Possible Configurations

For a more detailed explanation, refer to the Installation Manual.

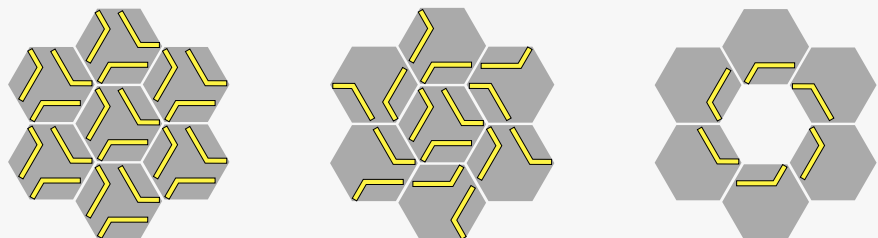



2 Optional Lighting

SoftGrid® Light - Attachment Details

\* Refer to Installation Manual or  
Contact Your Rep for More Info.

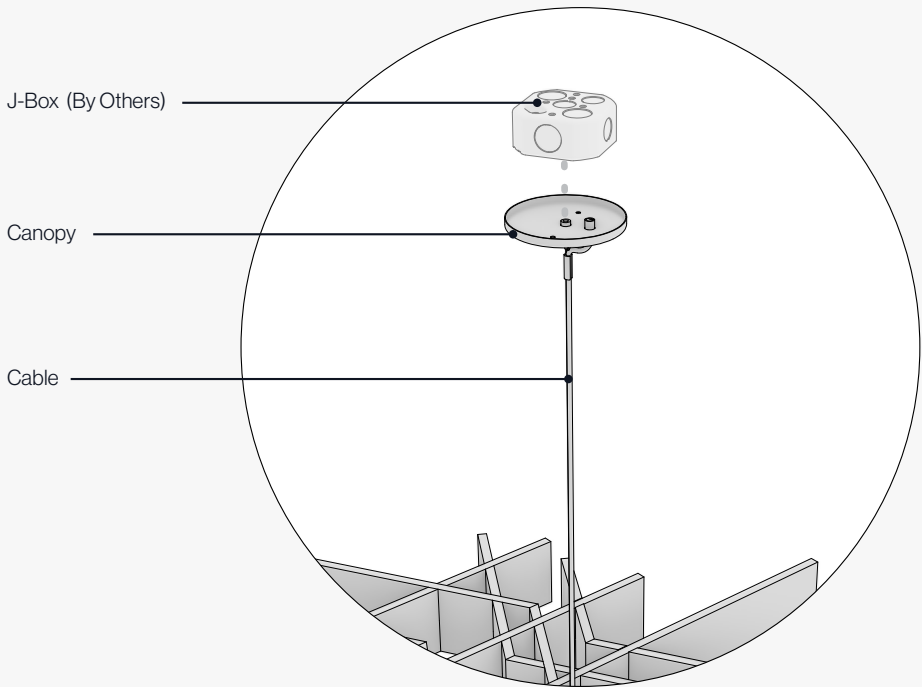
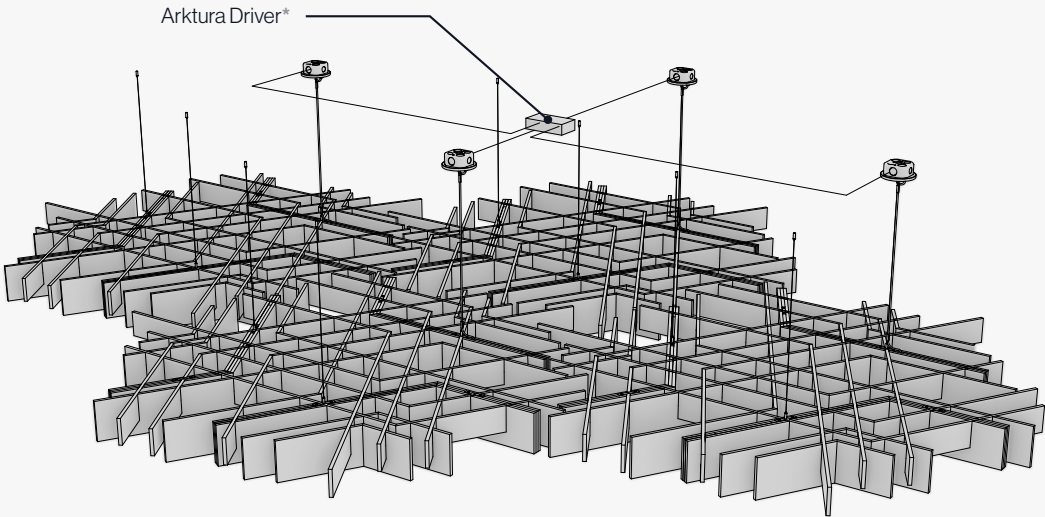

3

## Available Finishes

## Baffle Color

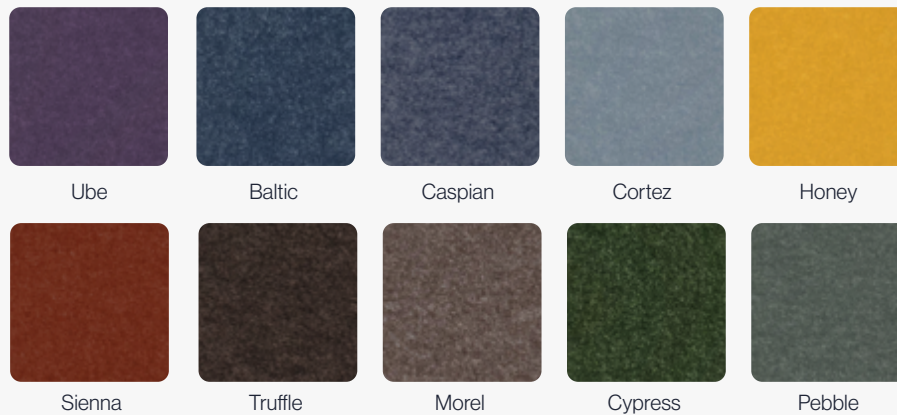
**Soft Sound®  
Vivids**  
Standard**Soft Sound®  
Elementals**  
Standard**Soft Sound®  
Wood Texture**  
Premium

① As with natural wood, variation in color and grain is expected and grain will not align across panels.

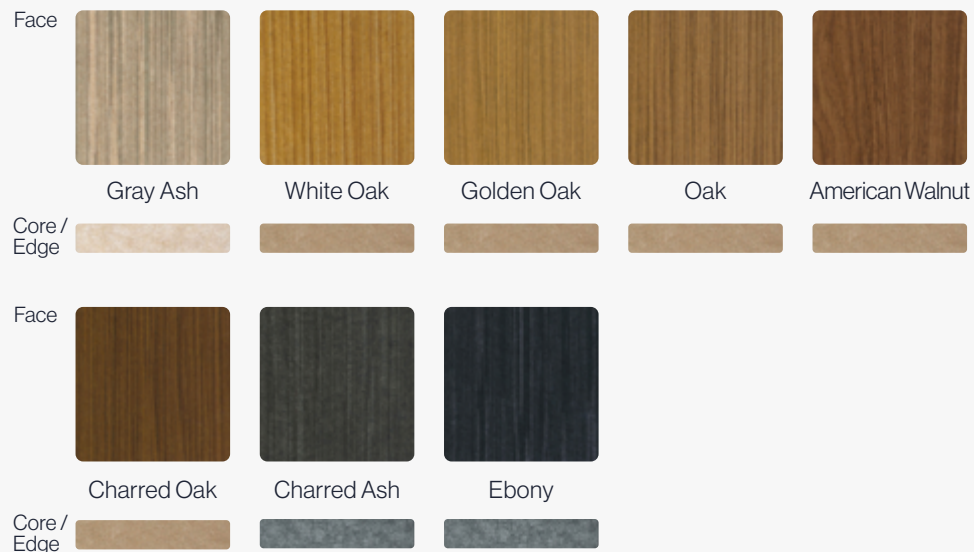

① Due to the nature of non-woven materials, light may pass through Soft Sound® in any thickness or color. A translucent appearance is most apparent in lighter colors and thin material when a light source is present behind the material. Arktura makes no claims or warranties about the material performing as opaque in any circumstance. To verify a products performance for light transmittance, a mockup of the specific intended use is recommended.

3 Available Finishes

Baffle Color

Soft Sound®  
Essentials  
Standard

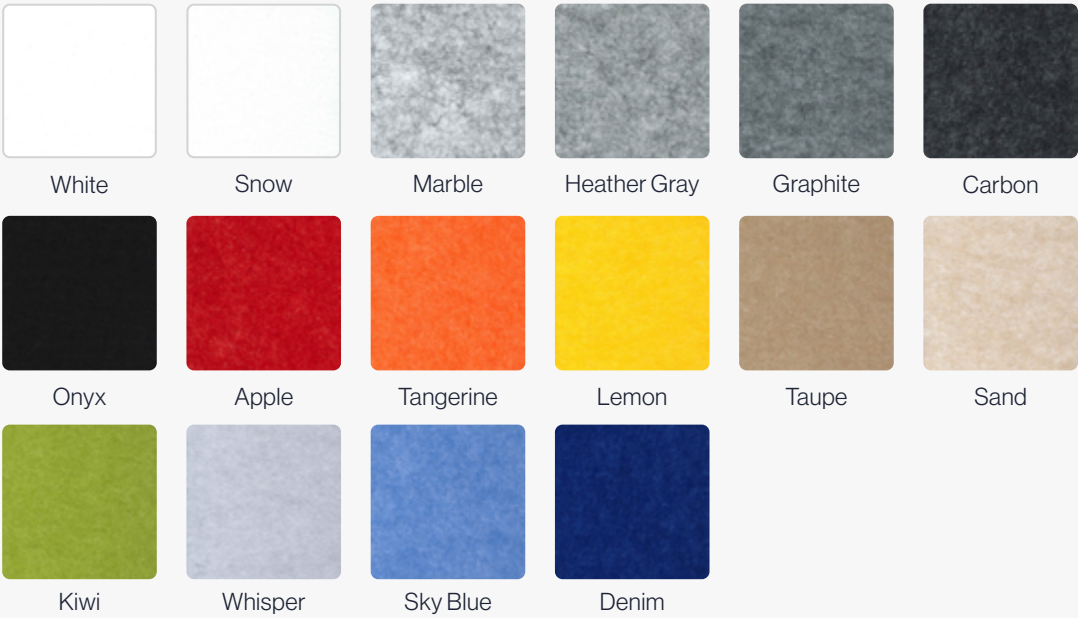

Duo Tone  
Optional

Select a primary and  
secondary color to  
Switch up each module.

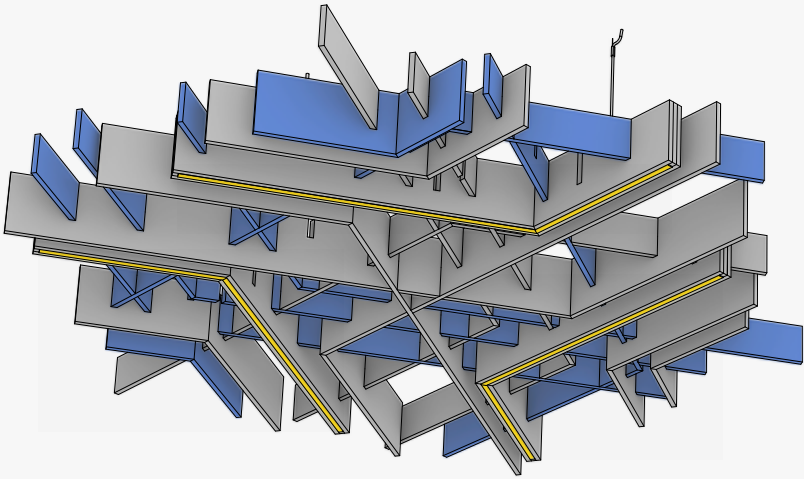

❗ Duo Tone is available in select patterns and sizes.

❗ Due to the nature of non-woven materials, light may pass through Soft Sound® in any thickness or color. A translucent appearance is most apparent in lighter colors and thin material when a light source is present behind the material. Arktura makes no claims or warranties about the material performing as opaque in any circumstance.



3

Available Finishes

Canopy Color

Canopy cover available in Arktura White and Jet Black (Matte), and cable to match.

\* Canopy can be field painted (by others).



Arktura White  
(Matte)



Jet Black  
(Matte)

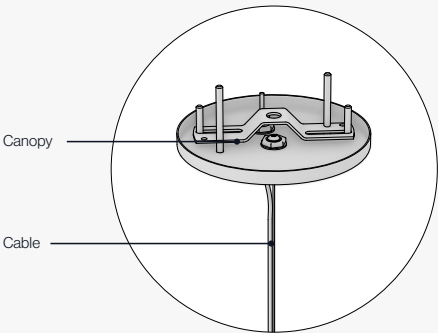

4

Product Specifications & Certifications

System Specs

Dimensions (WxLxD)	5'-9 <sup>5</sup> / <sub>16</sub> " x 5' x (Min. 3 <sup>3</sup> / <sub>4</sub> " Max. 5 <sup>5</sup> / <sub>8</sub> " )
Material	12mm Soft Sound® (PET), Stainless Steel
Openness in Plan	87%
Fire Rating	ASTME84 - Class A
Acoustics	True NRC® 0.60 (F-100 Method) True NRC® 0.65 (Mount Type A)
Attachment Method	1/32" Stainless Cable and Hardware
Accessibility	Yes, quick release cables
Trimmability	Yes, per installation manual

# Arktura SoftGrid® Light

Explore our specifications to find the perfect fit for your lighting project.

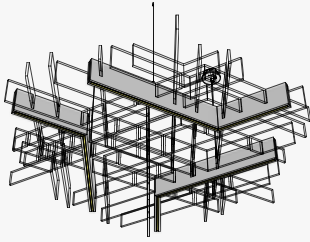

Flux

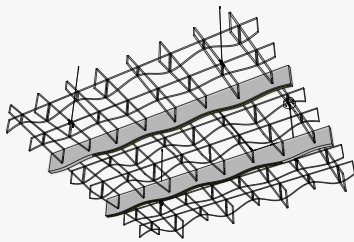

Sine

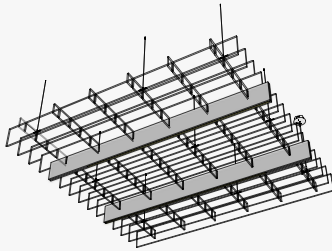

Square 6

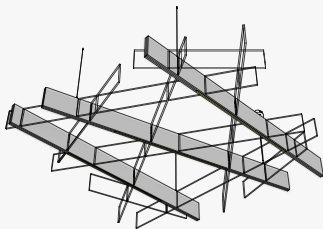

Switch

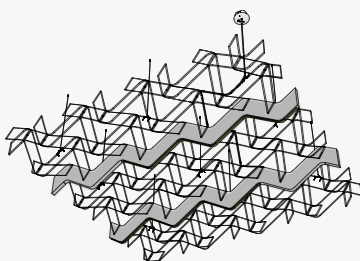

Wave

## Specs

<b>Power</b>	24VDC, 3.5W/FT
<b>Lens Aperture</b>	.472" x .48" per light fin (3 fins total)
<b>CRI</b>	90+
<b>Color Temperatures</b>	3000K, 3500K, 4000K**
<b>Operating Temperatures</b>	-20C - +50°C (-4F - +122°F)
<b>Dimming Options</b>	TRIAC/Phase, ELV, MLV, 0-10V, When Paired with Arktura LED Driver
<b>Cable</b>	UL Rated Cable 18AWG 10FT (Other length options available)
<b>Environment</b>	Indoor Locations Only
<b>Markings</b>	ETL Listed, Complies with UL 1598 & CSA C22.2#250.0:2021 Ed.5
<b>Lifetime</b>	L70 - 50,000 hours
<b>Warranty</b>	5 Years, Limited
<b>Dimensions</b>	15.5" x 44"
<b>Weight</b>	Flux: 26 lbs; Sine: 37.5; Square 6: 48.9; Switch: 46.7; Wave: 32 lbs.
<b>Materials</b>	PET, Silicone, Misc. RoHS compliant
<b>Installation Method</b>	Suspension Cable Hung

## Immersive Illumination



## Dimension

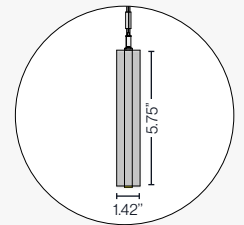

## Photometric

Located At Horizontal Angle = 0, Vertical Angle = 0

#1 - Vertical Plane Through Horizontal Angles (0 - 180) (Through Max. Cd.)

#2 - Horizontal Cone Through Vertical Angle (0) (Through Max. Cd.)

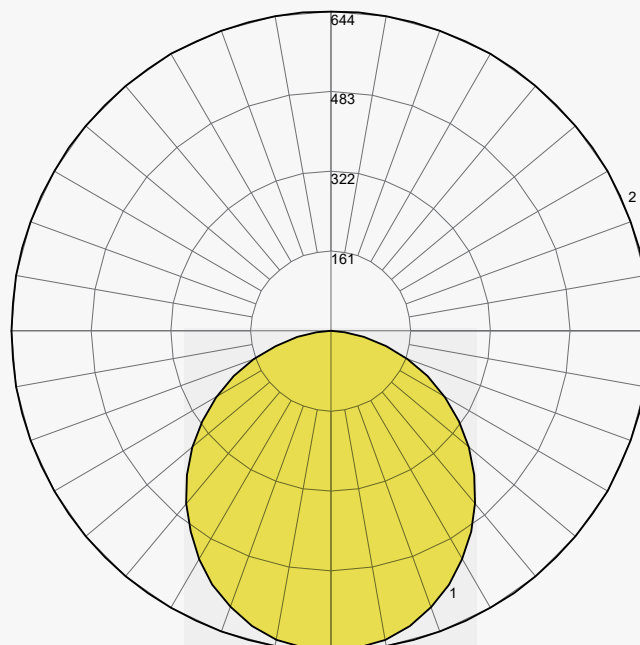

## Product Certifications

Electrical Safety Certification

Learn more at [intertek.com/marks/etl/](https://www.intertek.com/marks/etl/)

